

RoHS
Compliant

SYMBOL	REVISION	APPROVAL	DATE

SPECIFICATIONS

- ELECTRICAL CHARACTERISTICS:
 - 1-1.RATING: DC 12V 50mA
 - 1-2.CONTACT RESISTANCE: 500mΩ MAX(INITAL)
 - 1-3.DIELECTRIC WITHSTANDING VOL TAGE: 250V AC FOR ONE MINUTE
 - 1-4.INSULATION RESISTANCE: 100MΩ MIN,MEASURED BY 500V DC
- MECHANICAL CHARACTERISTICS:
 - 2-1.OPERATING FORCE :160±50gf
- LIFE TEST:ELECTRONICS LIFE TEST 300,000 CYCLES.

NOTES:SOLDER THICKNESS:0.08mm

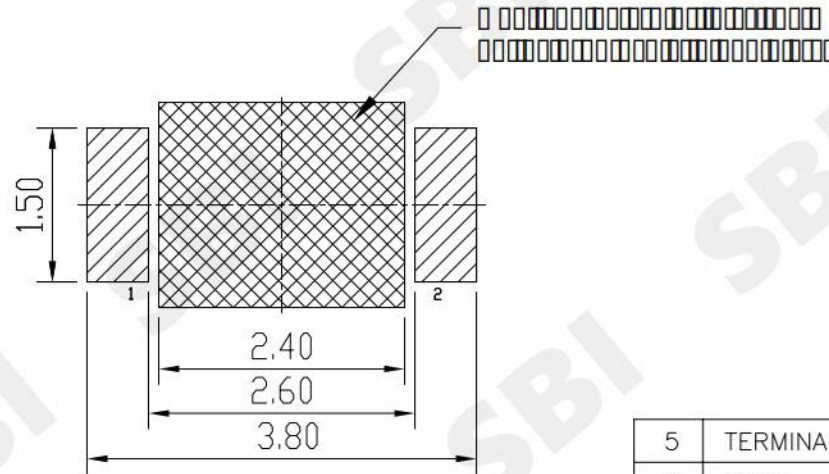
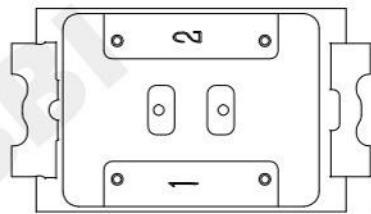
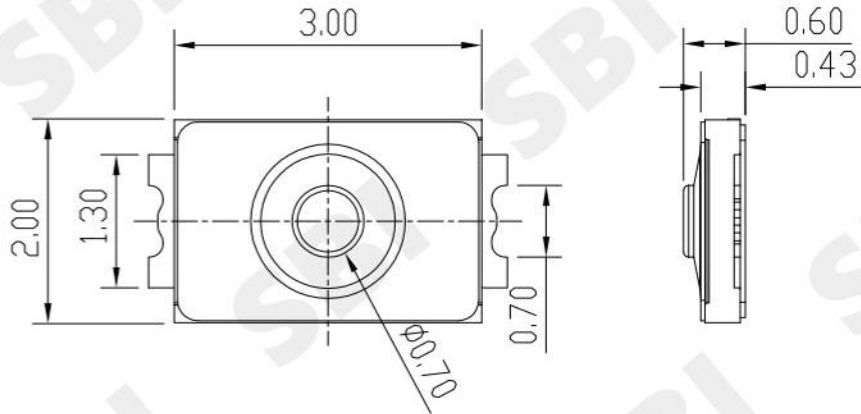

P.C.B LAYOUT
TOP VIEW

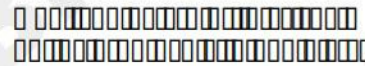

CIRCUIT

No.	DESCRIPTION	MATERIAL	QTY.	PLATING
5	TERMINAL	C5210	2	Ag PLATED
4	STEM	KAPTON	1	BLACK
3	PI	KAPTON	1	WHITE
2	DOME	SUS	1	Ag CLAD
1	CASE	LCP	1	BLACK

SMART BILLION INDUSTRIAL LIMITED

COPYRIGHT RESERVED,PLEASE DO NOT COPY.

PART NAME		TACT SWITCH(SMD)		DRAWING		Z.L.Liang		DWG.No.	
PART NO.		TS-2314S-160-TR		CHECK		G.C.Chen		REV. A0	
	UNIT : mm	TOLERANCE UNLESS OTHERWISE SPECIFIED	UP TO 5	±0.2	ANGLE	APPROVAL	G.C.Chen	DATE	2022/01/19
			ABOVE 5 ~30	±0.3					
SCALE		1:1		PAGE		1 OF 1			